

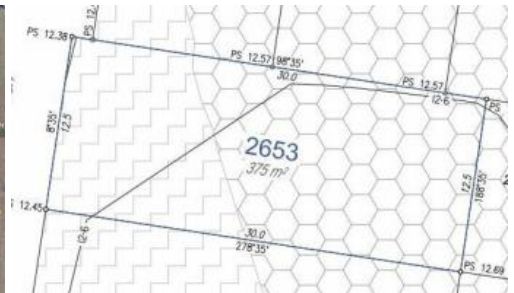

3 Bottlebrush Street, Palmview



## REGISTERED AND READY TO BUILD ON NOW

This beautiful and flat registered block is for sale and is situated only a few meters from Serenity Neighbourhood's Future Grand Linear Park! Serenity is yours at Harmony. Offering the best of both worlds, Serenity is not just peace and quiet, it's total peace of mind. Surrounded by swathes of Grand Linear Park, it's centrally located while also conveying a sense of escape. With the new Bruce Highway Access now open you'll find everything is no more than 15mins away, including the world famous, Mooloolaba Beach!

In today's property market, it's difficult to find a block at Harmony as they don't last long and even more rare to find a registered block! Harmony is one of the fastest growing master planned communities in Australia, where families looking for land for sale on the Sunshine Coast can find everything they've been looking for. This community truly has it all; proximity to amenities with a sense of peaceful seclusion. At Harmony, paths wind their way around tree-lined streets with countless parks for recreation. Whatever your lifestyle, your stage of life and plans for the future, you'll find the ideal address amongst Harmony's eight unique neighbourhoods reflect their distinctive settings. From peaceful streets nestled amidst natural bushland to manicured avenues leading to lush green reserves, brand new sports precincts and of course, Harmony's own proposed town centre, you've found the perfect place to build your new home. It is a community designed to bring people together, as it grows and evolves into one of Queensland's most attractive and connected communities.

375m<sup>2</sup>

**Price** SOLD for \$460,000  
**Property Type** Residential  
**Property ID** 10513  
**Land Area** 375 m<sup>2</sup>

### AGENT DETAILS

Emma Miles - 0424517064

### OFFICE DETAILS

Sippy Downs  
 Shop 2B/1 Chancellor Village  
 Boulevard Sippy Downs, QLD,  
 4556 Australia  
 07 5445 6500



Don't delay as this block won't last long. Call Emma today on 0424517064.

*The above information provided has been furnished to us by the vendor/s. We have not verified whether or not that information is accurate and do not have any belief in one way or the other in its accuracy. We do not accept any responsibility to any person for its accuracy and do no more than pass it on. All interested parties should make and rely upon their own inquiries in order to determine whether or not this information is in fact accurate.*