

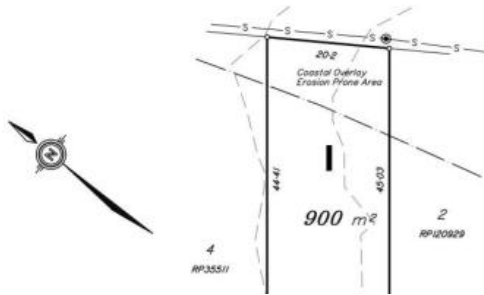

230 Charlton Esplanade, Pialba



ESPLANADE LAND OPPORTUNITY

Prime land on the Esplanade, with views across the Bay, ready to build your dream home, duplex or other development opportunities subject to Council approval.

- 900m2 with 20m frontage
- Development options including duplex
- Walk to beach, schools and shops

The above information provided has been furnished to us by the vendor/s. We have not verified whether or not that information is accurate and do not have any belief in one way or the other in its accuracy. We do not accept any responsibility to any person for its accuracy and do no more than pass it on. All interested parties should make and rely upon their own inquiries in order to determine whether or not this information is in fact accurate.

📏 901m2

Price SOLD for \$435,000
Property Type Residential
Property ID 2935
Land Area 901 m2

AGENT DETAILS

Justin Voss - 0400 822 069

OFFICE DETAILS

Hervey Bay and Burrum Heads
 1/3 Ivor Drive Burrum Heads, QLD,
 4659 Australia
 0434 342 232

